

Order #49478 - ECO-1056 eSmart 10'x10' Sustainable Hybrid Display

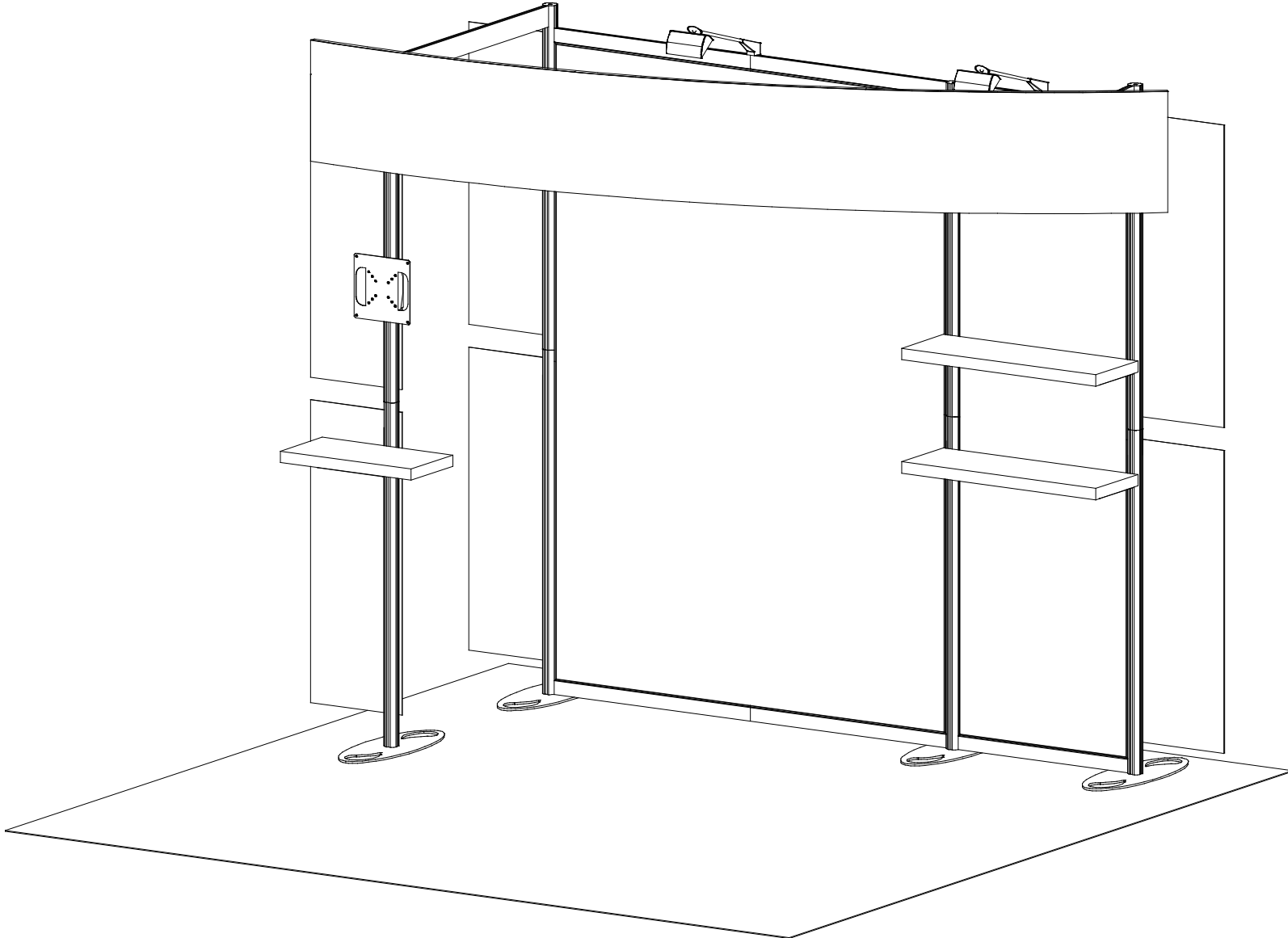

Perspective View

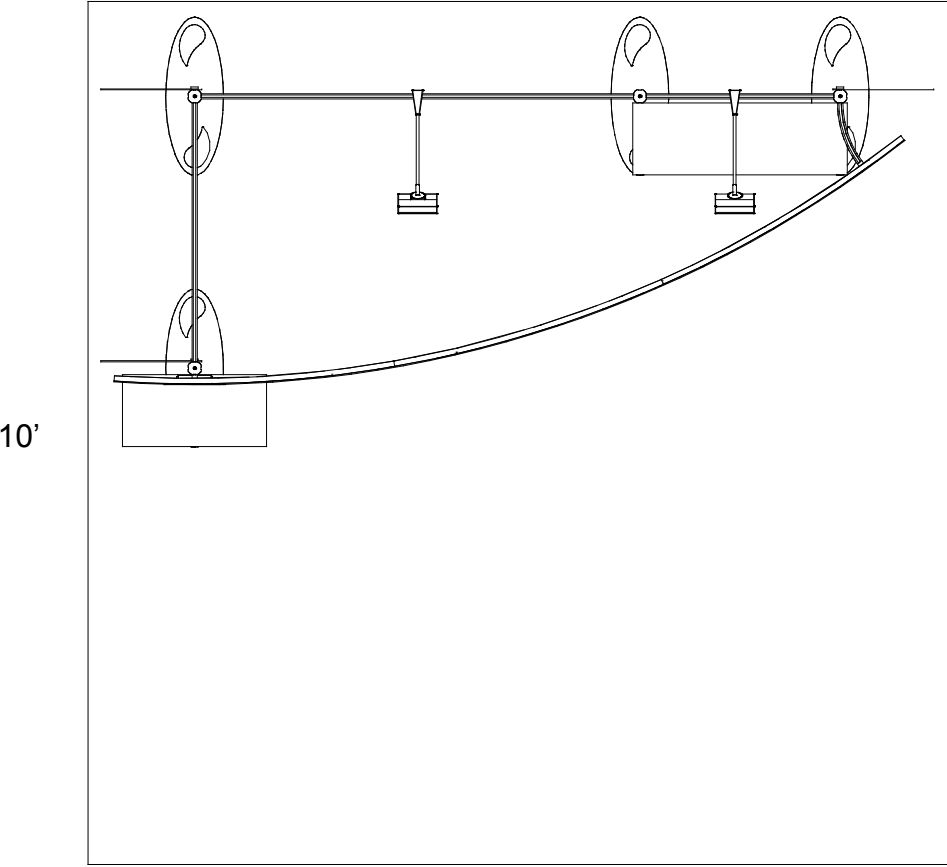

10'

Plan View

ecosystems™
SUSTAINABLE EXHIBITS
YOUR BRAND. YOUR DESIGN. YOUR PLANET.

General Setup Instructions

- The setup instructions are created specifically for your configuration.
- Setup instructions are laid out sequentially in levels, including exploded views and a logical series of steps for assembly. We encourage you to study the instructions before attempting to assemble your exhibit.

Cleaning and Packing

- Use non-abrasive cleaners when cleaning extrusions or ECO Glass inserts.
- Use mild cleaners and soft materials such as cotton to clean all laminates.
- Keep exhibit components away from extreme heat and long exposure to sun light. This will prevent warping and fading.
- Retain all packing material for ease of re-packing. This protects the exhibit components and keeps each part organized.

Disassembling

- When disassembling exhibit, tighten all setscrews to prevent loss of hardware in the shipping process.

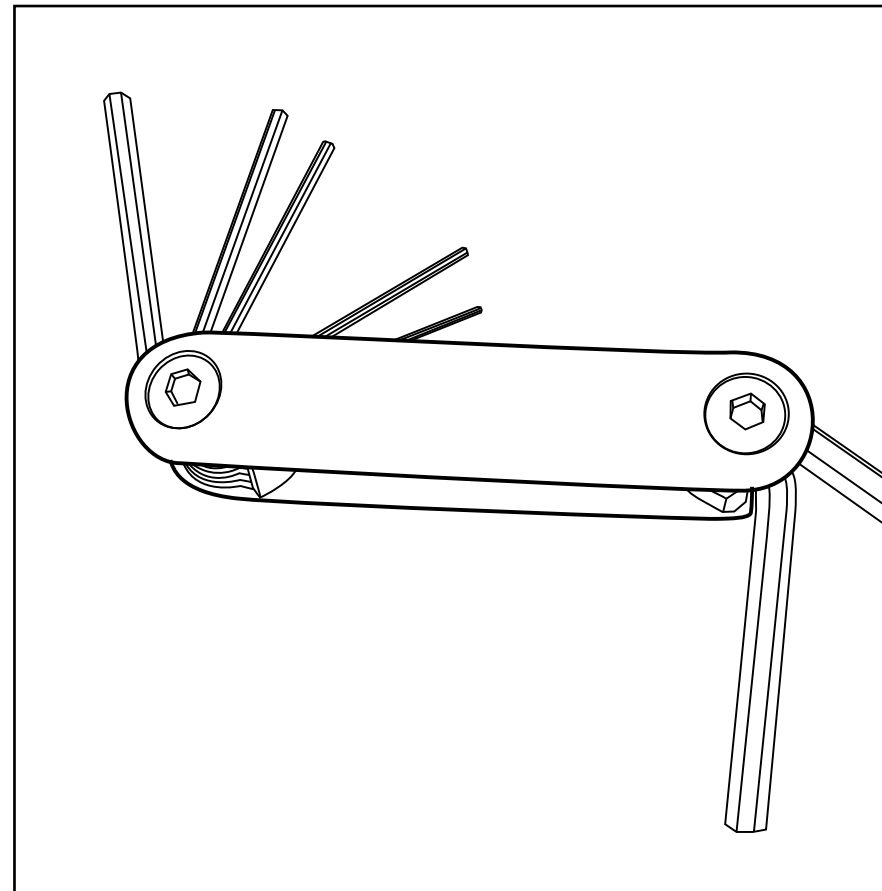

Hex Tool for Assembling Exhibit

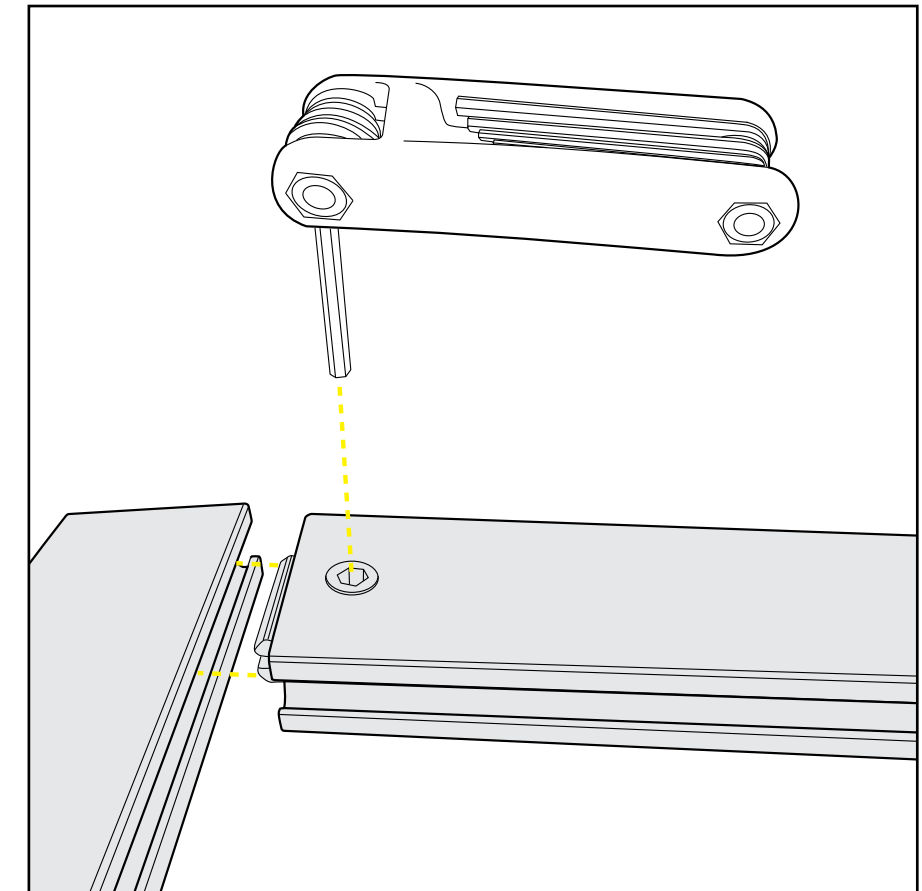

Extrusion Lock Connectors

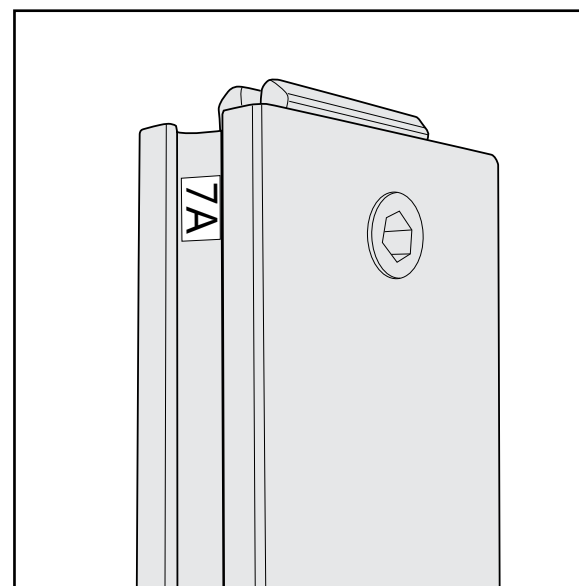

Numbering Instructions for Setups/Packing

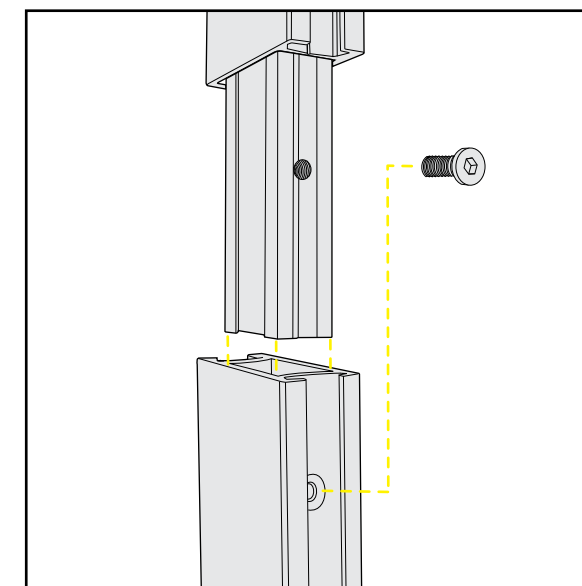

Inline Connection between Extrusions

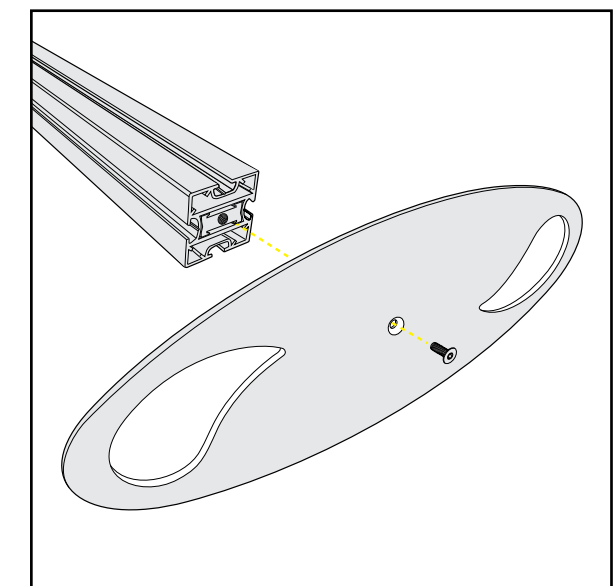

Baseplate Connection for Vertical Extrusions

ECO Panel Install

- 1 Place ECO panel together with a vertical offset, slide down to lock connector in place.
- 2 Panel Corner Connectors are installed just like ECO panels. Remove by off-setting top lock clips horizontally followed by separating vertically.

SEG Graphic Install

- 1 Graphic is installed corners first. This allows a proportional fit around the perimeter of the extrusion.
- 2 Locate channels along the edge of the extrusions.
- 3 Fold over graphic (hiding threads) and tuck silicon edge and fabric into corners.
- 4 After corners are complete, slide in the rest of the graphic into channel. (From edges to center)
- 5 Graphic is installed. Stand back and be amazed!

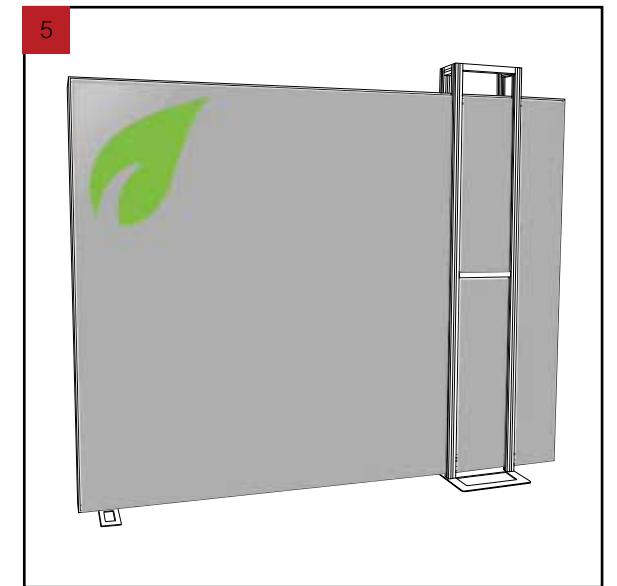
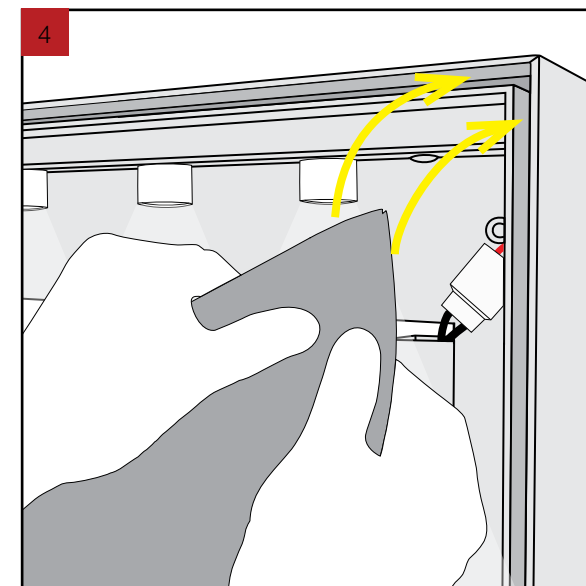
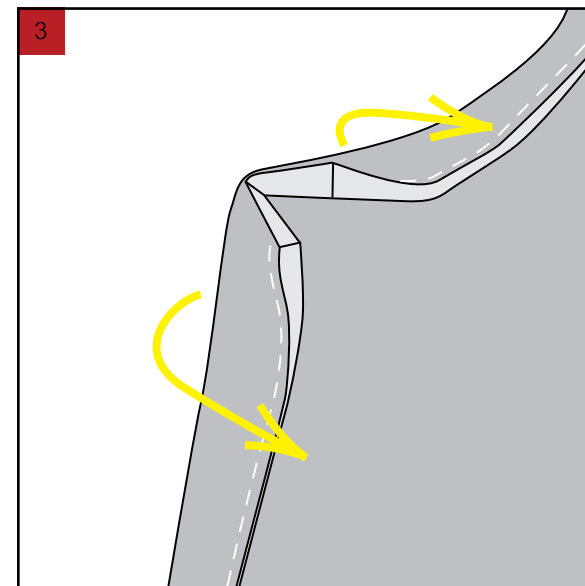
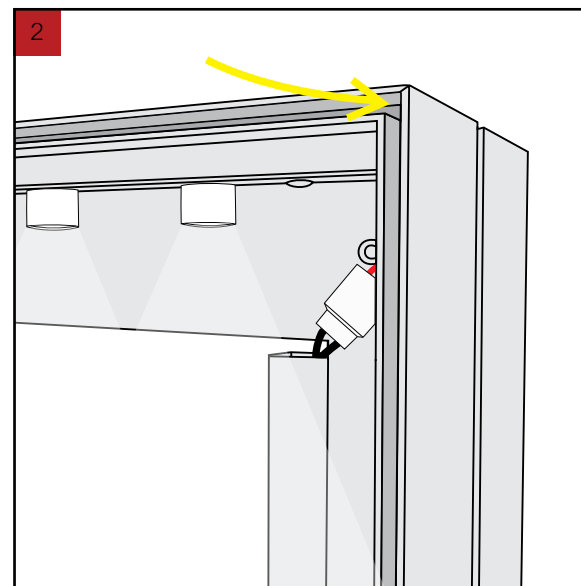
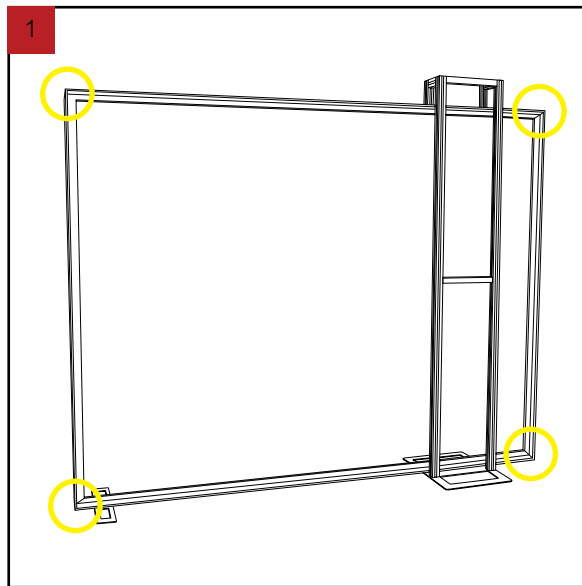
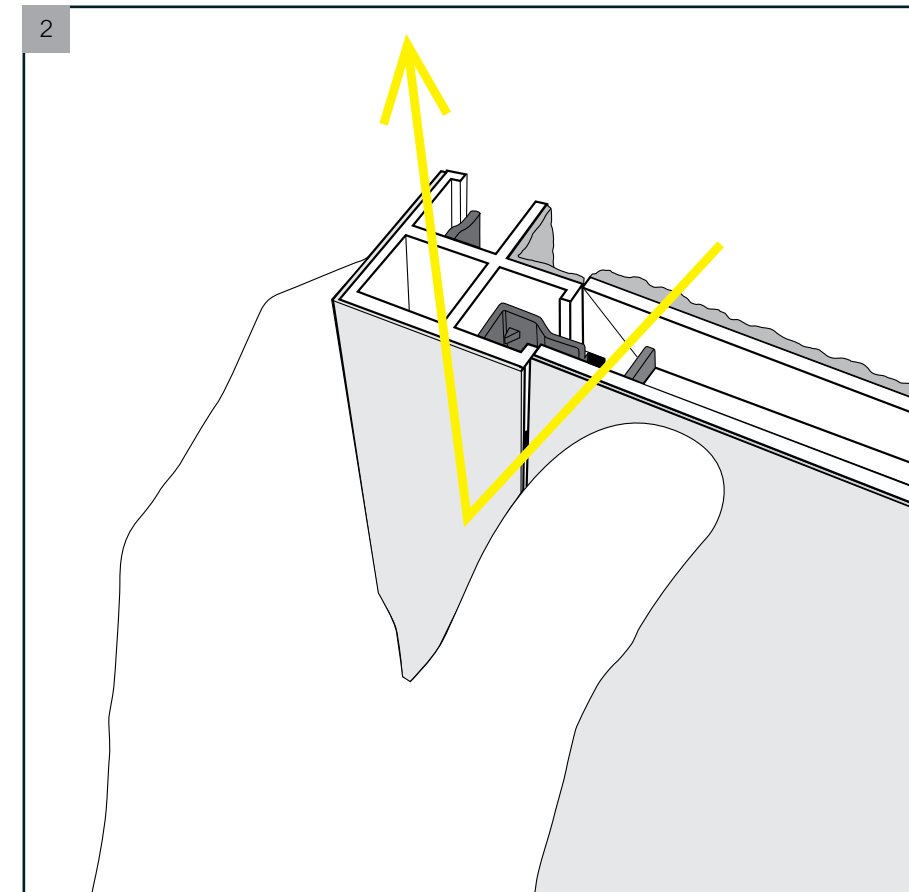
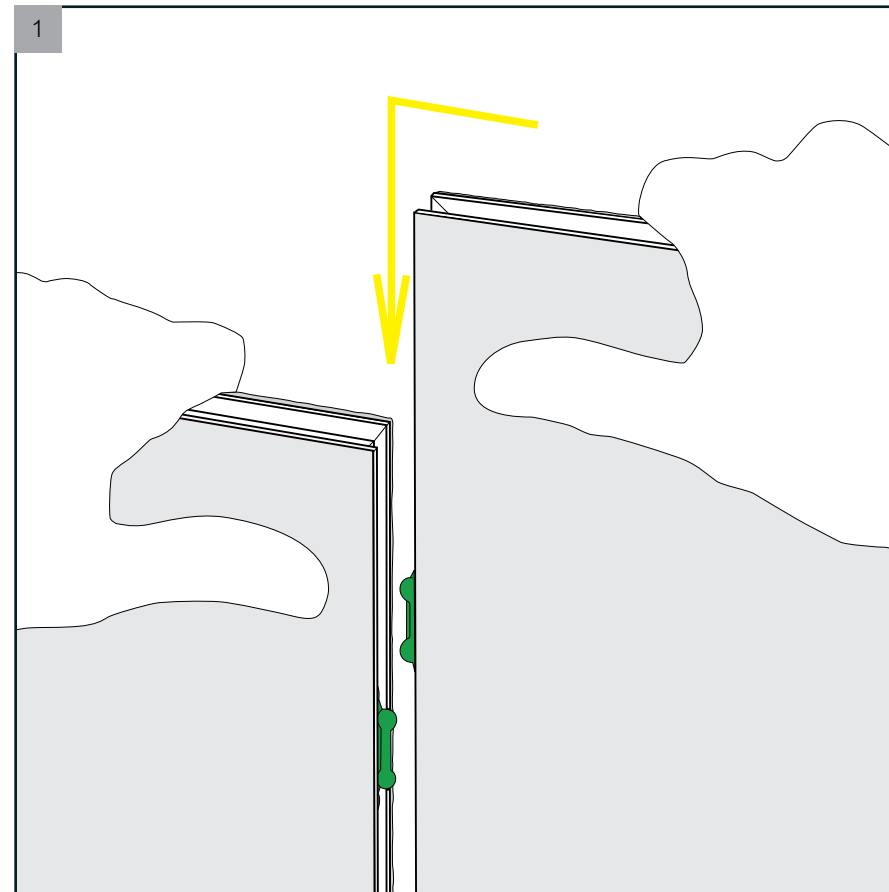

Top View of Each Level

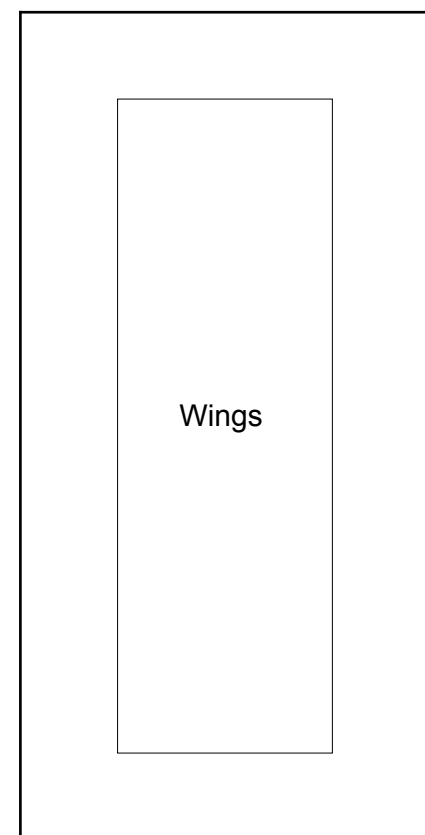

Level 1

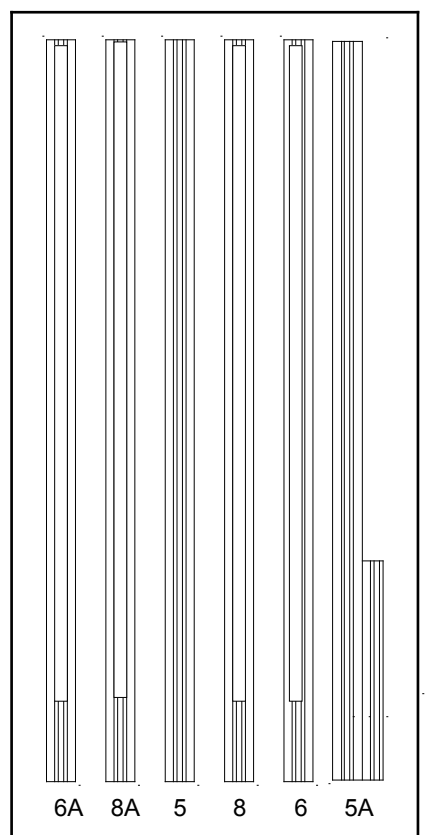

Level 2

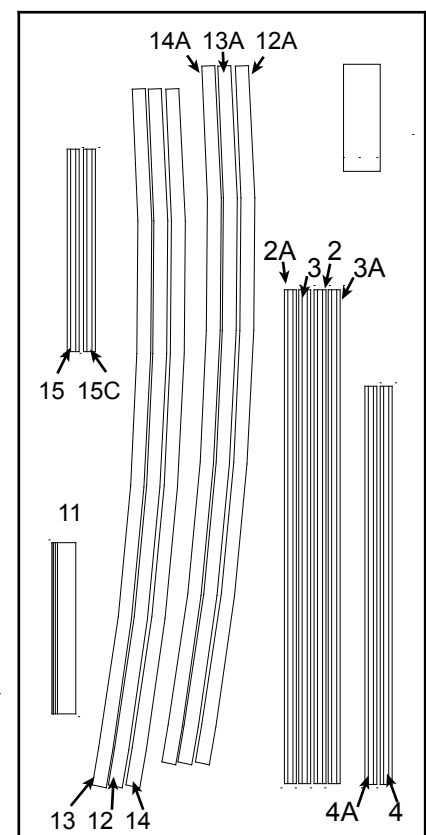

Level 3

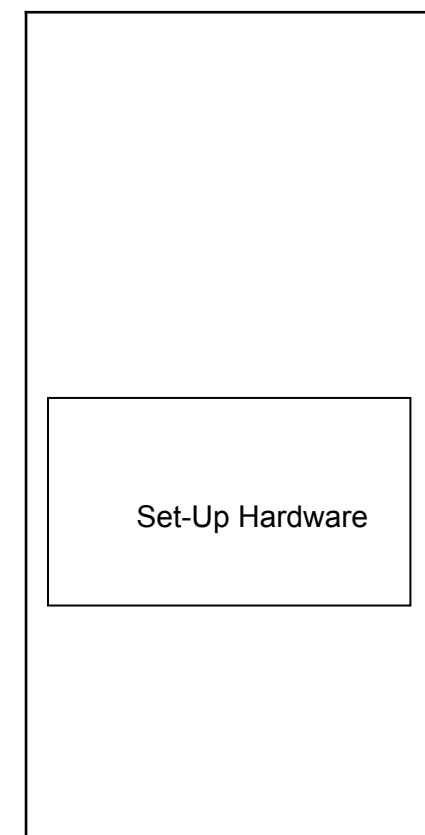

Level 4

Top View of Each Level

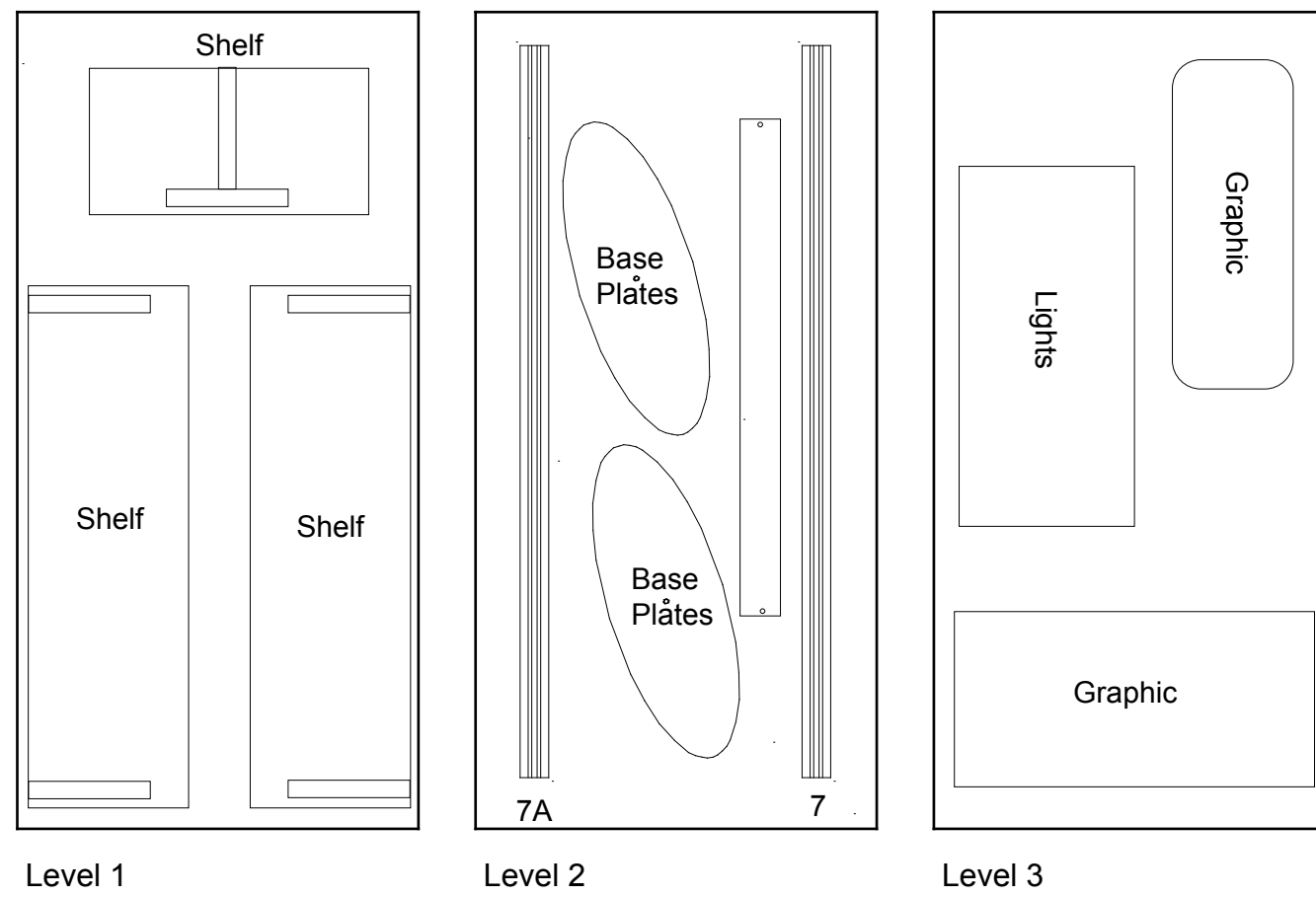

Item	Qty.	Description
1	4	Baseplate
2/2A	1/1	30" Horizontal Extrusion
3/3A	1/1	30" Horizontal Extrusion
4/4A	1/1	26" Horizontal Extrusion
5/5A	1/1	45.5" Vertical Extrusion
6/6A	1/1	45.5" Vertical Extrusion
7/7A	1/1	44" Vertical Extrusion
8/8A	1/1	44" Vertical Extrusion
9	1	36" Horizontal Extrusion
10	1	9.025" Curved Horizontal Extrusion
11	1	13.48" Vertical Extrusion

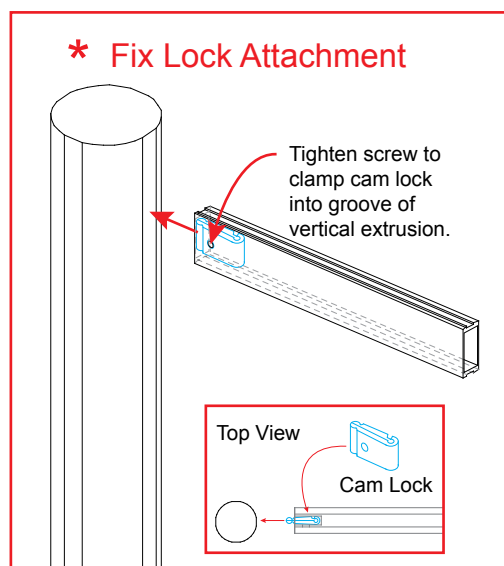

Steps:

- 1) Attach Baseplates [1] to ends of Vertical Extrusions [5, 6, 7, 8].
- 2) Connect Verticals [5A, 6A, 7A, 8A] to ends of Verticals [5, 6, 7, 8].
- 3) Connect Horizontals [2-3, 2A-3A] together.
- 4) Connect assembled Horizontals between Verticals [6-6A, 7-7A].
- 5) Connect Horizontals [4, 4A] between assembled Verticals [7-7A, 8-8A].
- 6) Connect Horizontal [9] between Verticals [5-5A, 6-6A].
- 7) Attach Curved Horizontal [10] to top of Vertical [8A].
- 8) Attach Vertical [11] to end of Horizontal [10].
- 9) Attach Monitor Mount as shown (see Detail).

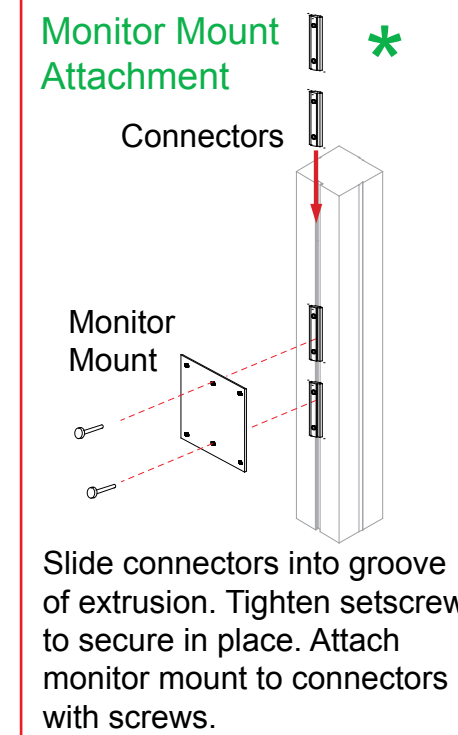
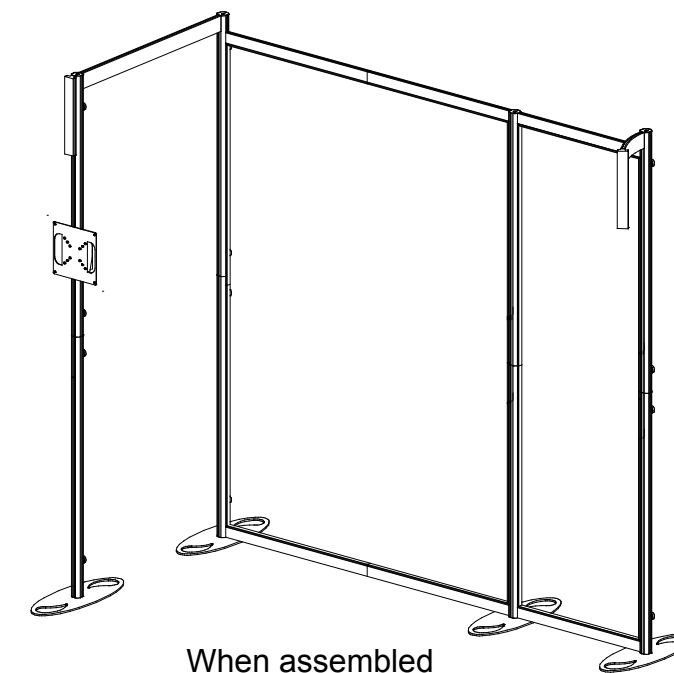
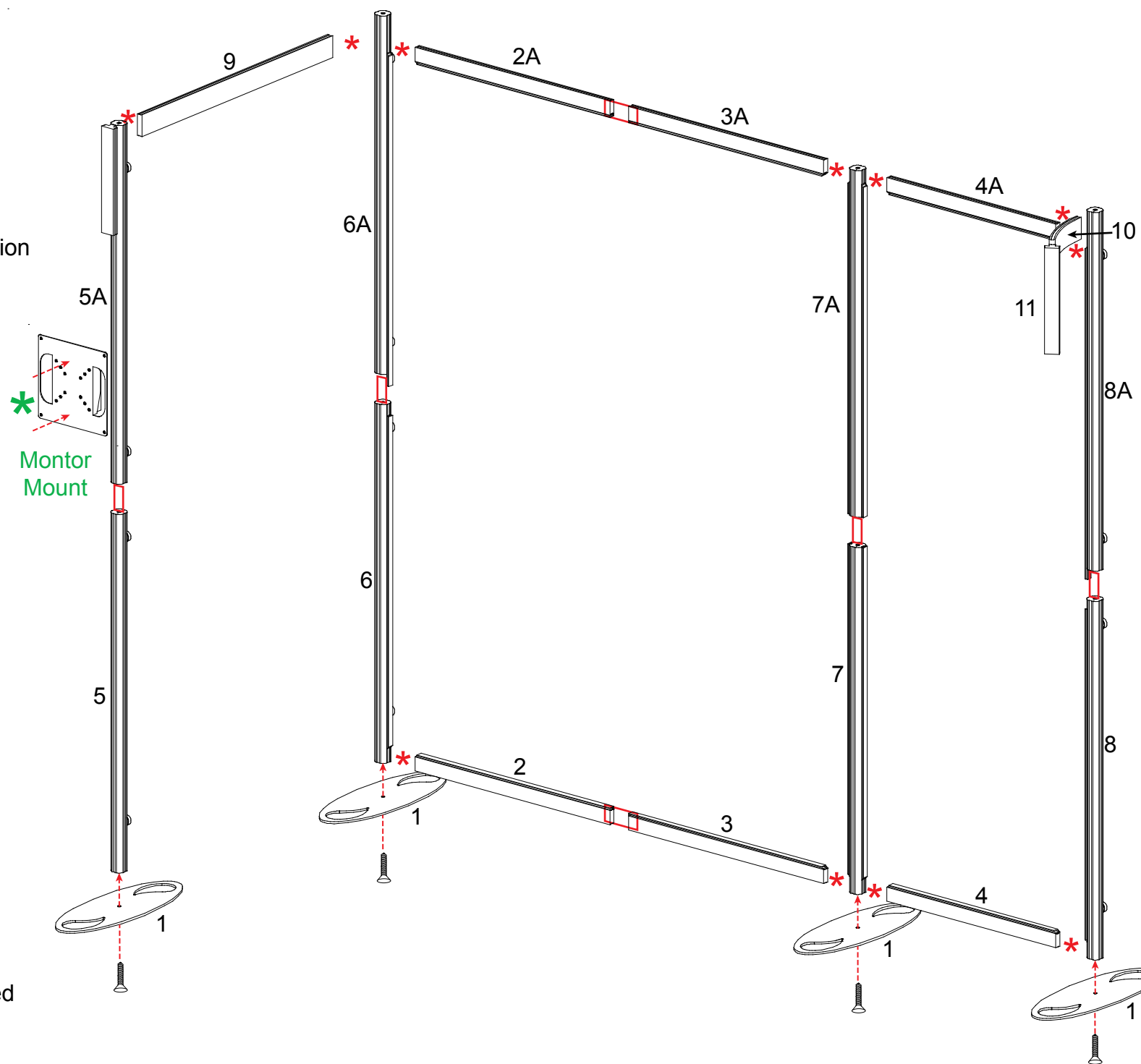

Step 1

Steps:

- 1) Attach wings to Verticals with Standoff Caps as shown.
- 2) Attach Shelves to Verticals with Cam Locks.
- 3) Connect lights to top Horizontal Extrusions.

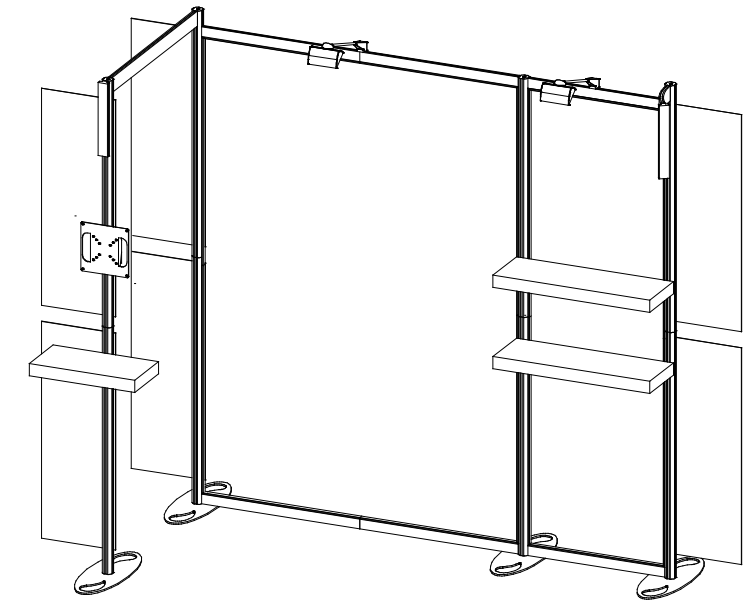
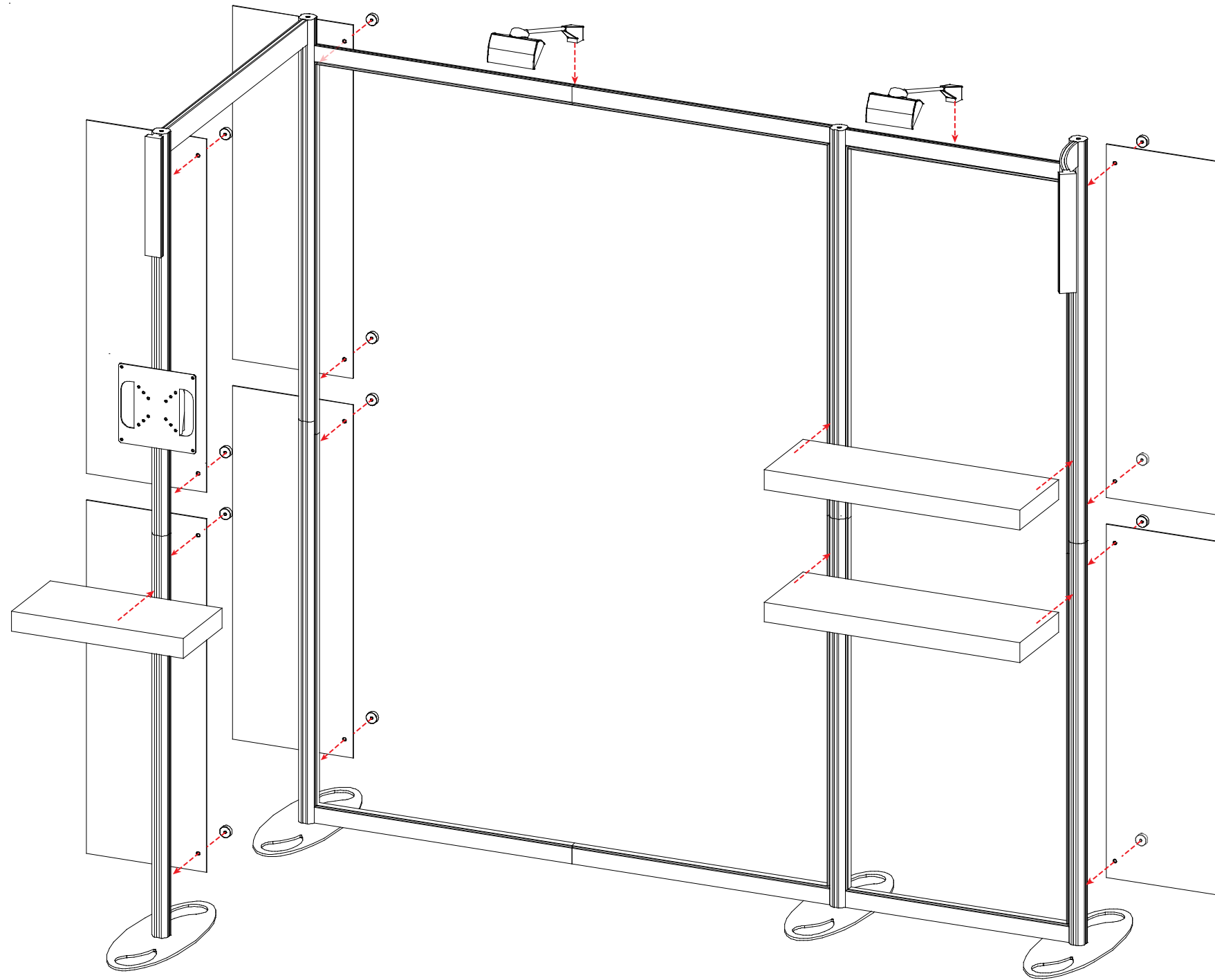

When assembled

Step 2

Item	Qty.	Description
12/12A	1/1	39.097" Curved Horizontal Extrusion
13/13A	1/1	39.097" Curved Horizontal Extrusion
14/14A	1/1	39.097" Curved Horizontal Extrusion
15/15A/15B/15C	1/1/1/1	13.48" Vertical Extrusion

Steps:

- 1) Connect Curved Horizontals [12-13-14 & 12A-13A-14A] together (see Horizontal Inline Detail).
- 2) Connect Verticals [15, 15A, 15B, 15C] between assembled Horizontals as shown (see Cam Lock Detail).
- 3) Attach assembled header to assembled backwall as shown (see Detail).

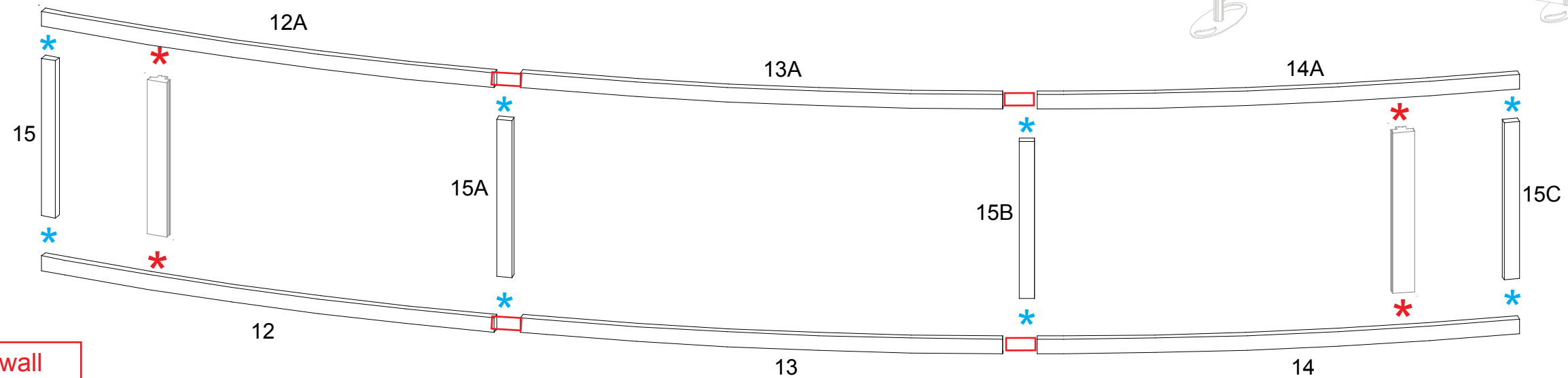
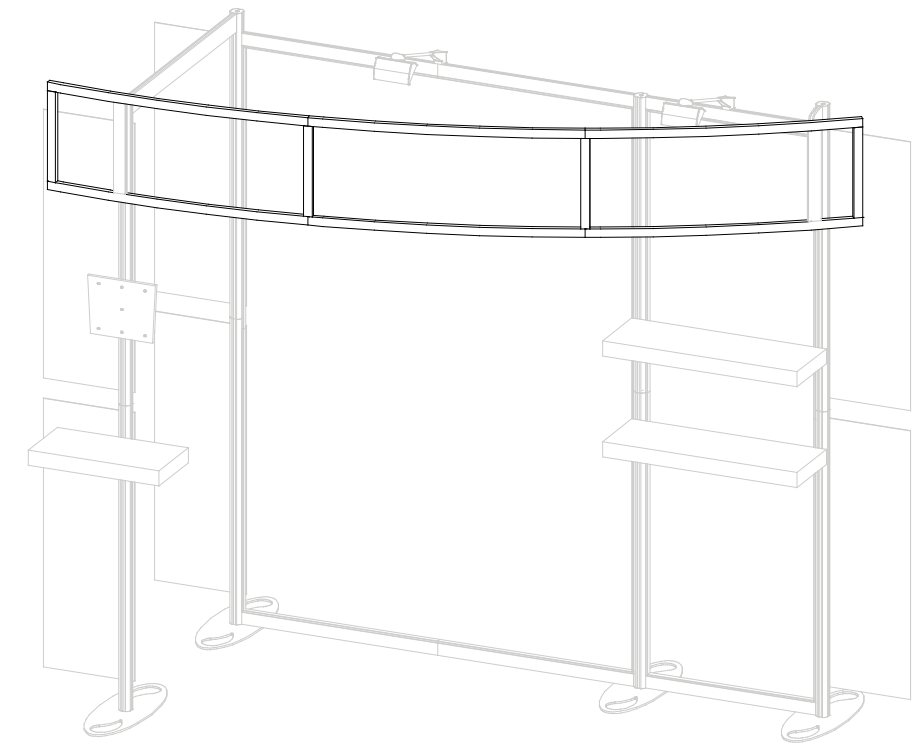

*** Header to Backwall Attachment**

Place Cam Locks of Backwall Verticals into groove of Header Horizontals, then tighten set screw to secure.

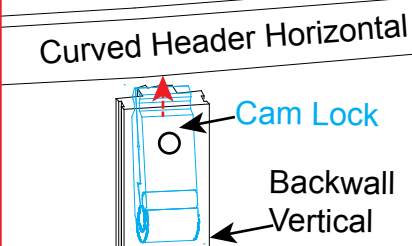

*** Cam Lock Detail**

