

WHEN DISASSEMBLING ALUMINUM EXTRUSION, TIGHTEN ALL SETSCREWS AND LOCKS TO PREVENT LOSS DURING SHIPPING



Part Number	Qty for Step	Description
1	1	Base Plate
2	1	72" h Half Round Vertical extrusion
3	1	Base Plate
4	1	72" h Half Round Vertical extrusion
5	1	36" h Lower Horizontal extrusion
6	1	36" h Lower Horizontal extrusion
7	1	36" h Upper Horizontal extrusion
8	1	36" h Upper Horizontal extrusion

Steps

- 1) Connect base plates [1 and 3] to vertical assemblies [2 and 4].
- 2) Connect lower horizontal extrusions [5 and 6] between vertical assemblies [2 and 4] as shown.
- 3) Connect upper horizontal extrusions [7 and 8] between vertical assemblies [2 and 4].
- 5) Place lights staggered inside the vertical extrusions making sure to run cords down thru bottom opening.
- 6) Place Sintra Cap atop assembled lightbox.

Note: Front Graphic is SEG, back graphic applies via Velcro to INSDIE of verticals.

Graphic: To Ensure Proper Fit

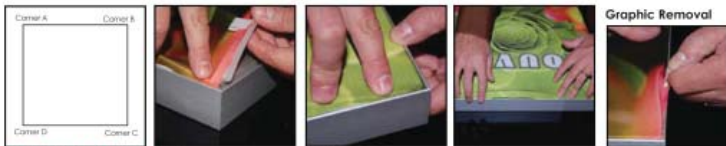

It is important to first insert graphic into each alternate corner then to the sides of the frame. If this is not done, graphic will not fit into the frame correctly.

Step 1
Insert corner A. Turn edge of graphic so silicon well is perpendicular to face of graphic. Insert narrow side of well with fabric to outside into the channel. Repeat for other side of this corner.

Step 2
Repeat Step 1 for opposite corner C, then insert corner B, followed by corner D, to complete the installation of the corners.

Step 3
Once all corners are inserted, press one silicon edge into the frame, locate the fabric pul tabs. Gently pull up on the tab to remove the fabric. Make sure well is fully inserted into channel. Continue until all sides are done. Smooth out edges of graphic.

Graphic Removal
To remove the graphic from the frame, locate the fabric pul tabs. Gently pull up on the tab to remove the fabric.

